

REVISION	DATE
ABC	---

TRADITION HALL
3300 Elvington Loop
Conway, SC 29526

TRADITION HALL
3300 BUILDING
SECOND FLOOR PLAN
BUILDING CODE: TD33 IDENTIFICATION NUMBER: 633

FACILITIES DESIGN &
ENGINEERING
P.O. BOX 261954
CONWAY, SC 29528

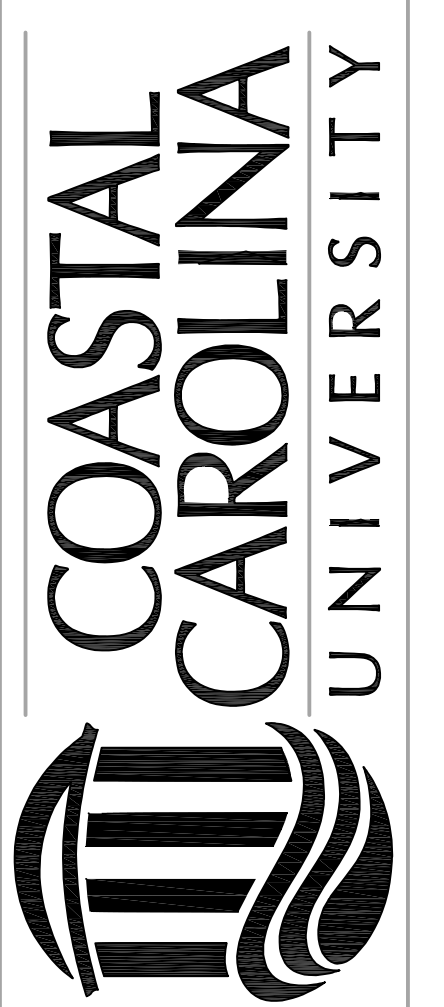

SEAL

DATE: 10-30-2015
SCALE: 1/4" = 1'-0"
DESIGN BY: CCU
DRAWN BY: CDW
SHEET

A-2
of 3

↑
TO
ELVINGTON
LOOP

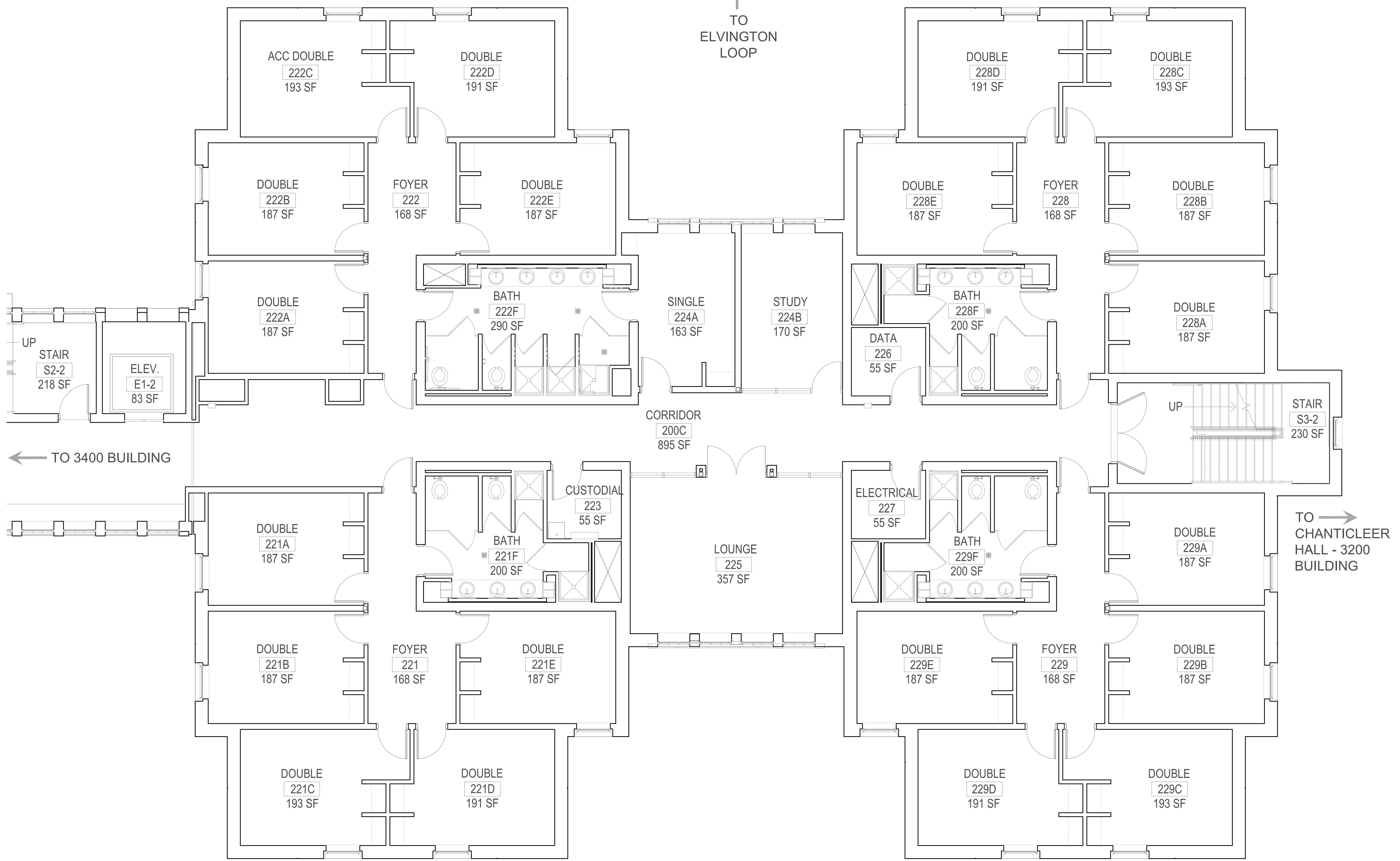

← TO 3400 BUILDING

TO →
CHANTICLEER
HALL - 3200
BUILDING

SECOND FLOOR PLAN - 3300 BUILDING
SCALE: 1/4" = 1' - 0"

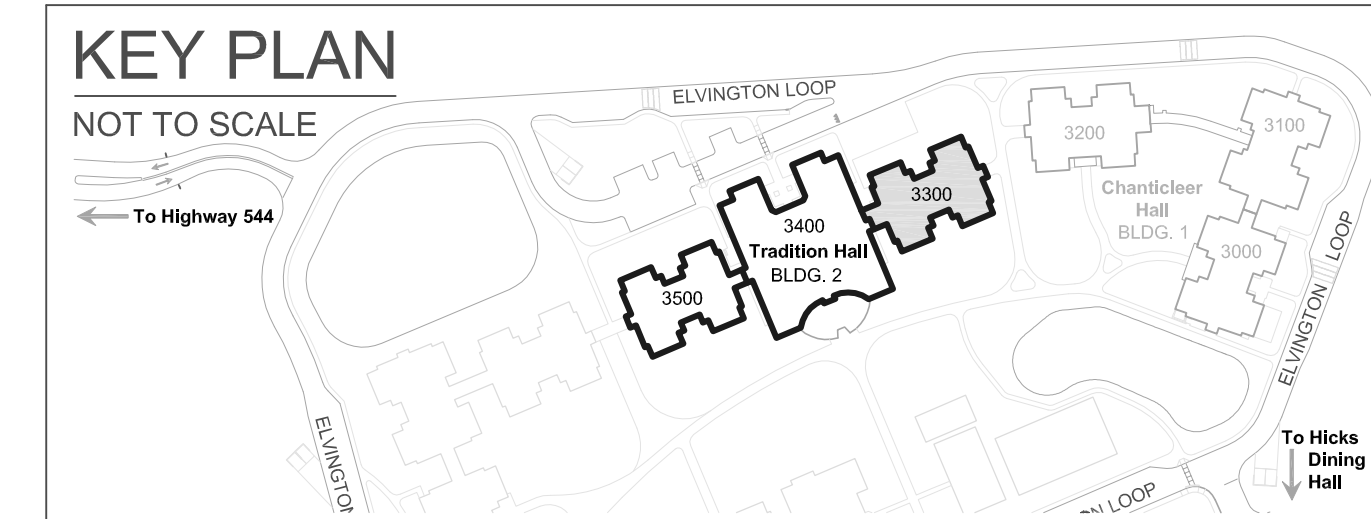

TRADITION HALL
3300 BUILDING
SECOND FLOOR PLAN
TOTAL NET SQUARE FOOTAGE = 6,009
TOTAL GROSS SQUARE FOOTAGE = 8,938
TOTAL LINEAR FEET = 539'