

REVISION	DATE
ABC	---
TRADITION HALL 3500 Elvington Loop Conway, SC 29526	
TRADITION HALL 3500 BUILDING THIRD FLOOR PLAN BUILDING CODE: TD35 IDENTIFICATION NUMBER: 635	
FACILITIES DESIGN & ENGINEERING P.O. BOX 261954 CONWAY, SC 29528	
 COASTAL CAROLINA UNIVERSITY	
SEAL	
DATE: 10-30-2015 SCALE: 1/4" = 1'-0" DESIGN BY: CCU DRAWN BY: CDW SHEET	
A-3 of 3	

↑
TO
ELVINGTON
LOOP

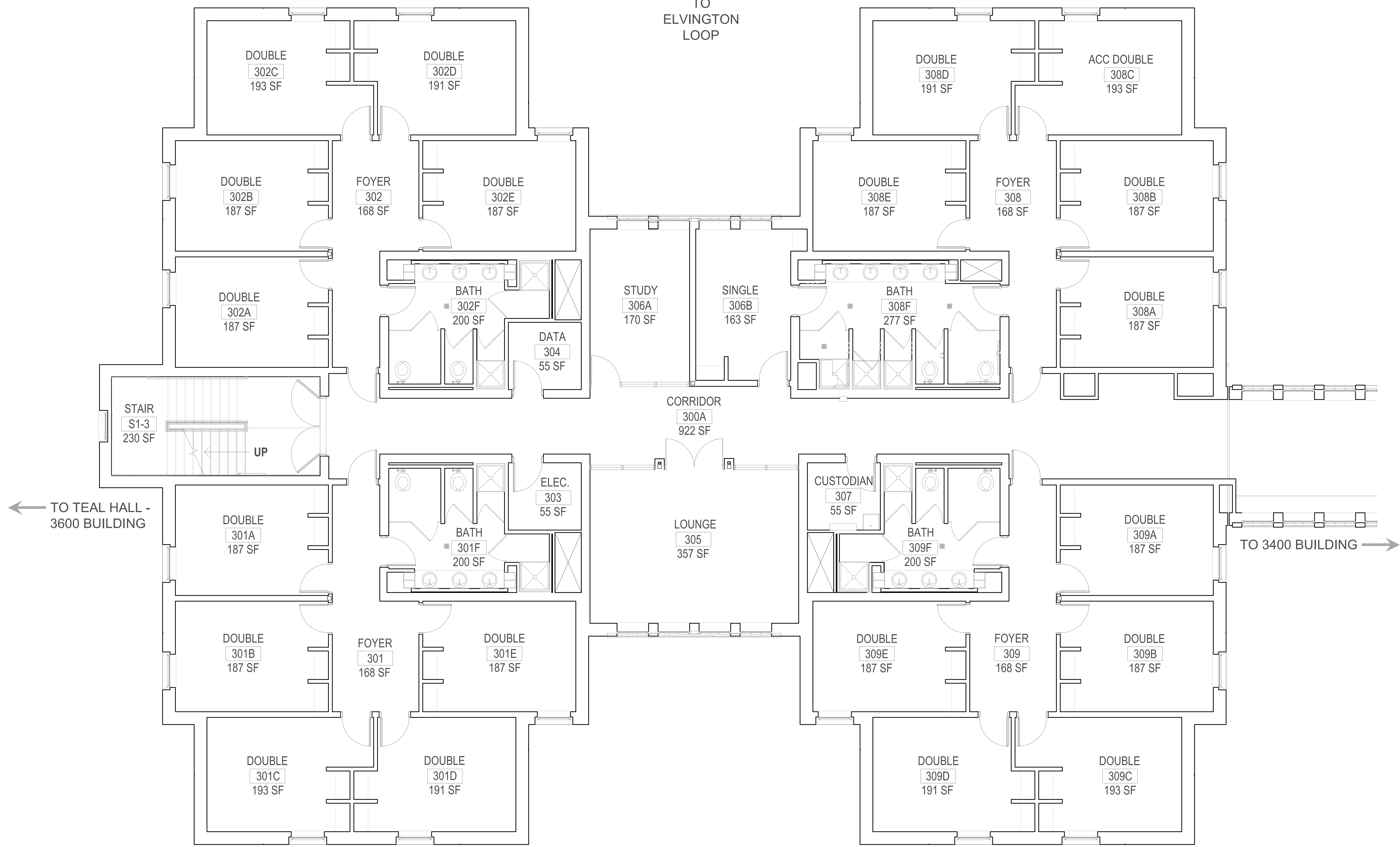

THIRD FLOOR PLAN - 3500 BUILDING
SCALE: 1/4" = 1' - 0"

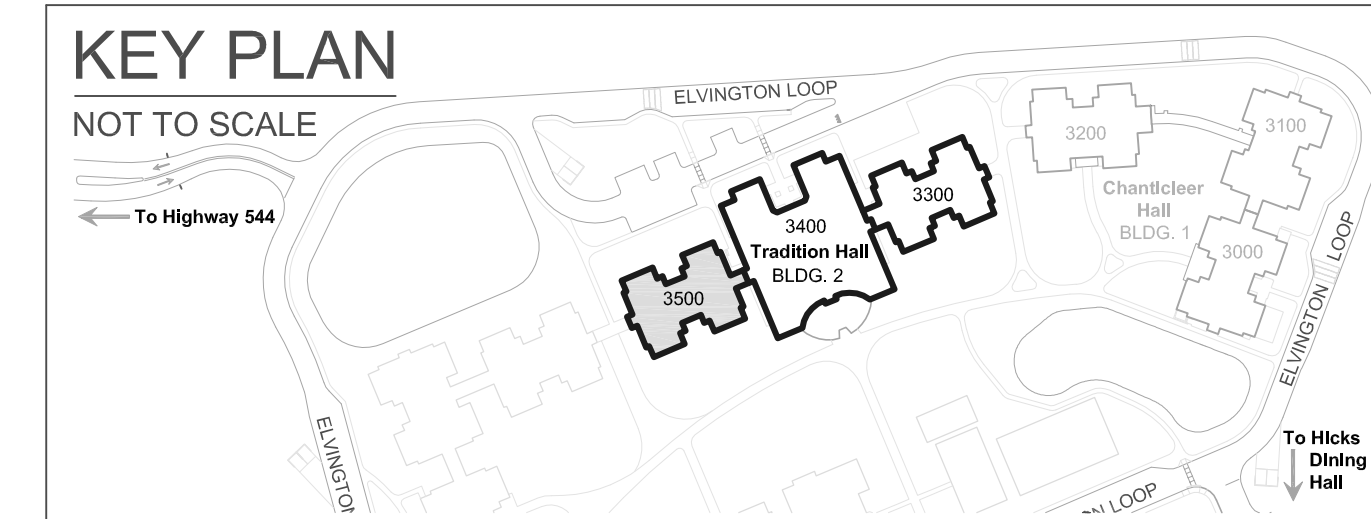

TRADITION HALL
3500 BUILDING
THIRD FLOOR PLAN
TOTAL NET SQUARE FOOTAGE = 6,026
TOTAL GROSS SQUARE FOOTAGE = 8,777
TOTAL LINEAR FEET = 537'